



**WALL(W)**

- W01 INTERNAL TIMBER FRAMED WALL.**  
90x45mm - Grade SG8 - H1.2 treated timber framed internal wall with studs as per framing table, and noggs at 800 crs. to comply with NZS3604, 2011. Line both sides with 10mm GIB standard stopped to level 4 for selected paint finish. In wet areas line walls with 10mm GIB Aqualine.
- W02 EXTERNAL TIMBER FRAMED WALL VERTICAL SHIPLAP-CAVITY BATTEN.**  
90x45mm - Grade SG8 - H1.2 treated timber framed external wall with studs at 600 crs. and noggs at 480 crs. to NZS 3604, 2011. Clad exterior with JAMES HARDIE LINEA OBLIQUE vertical(200mm wide or similar) weatherboard over building wrap over timber cavity batten. Line internal walls with 10mm GIB standard stopped to level 4 for selected paint finish.
- W03 EXTERNAL TIMBER FRAMED WALL. BEVEL BACK WEATHERBOARD - CAVITY BATTEN.**  
90x45mm - Grade SG8 - H1.2 treated timber framed external wall with studs at 600 crs. and noggs at 800 crs. to NZS 3604, 2011. Clad exterior with JAMES HARDIE LINEA OBLIQUE horizontal(200mm wide or similar) weatherboard over building wrap over timber cavity batten. Line internal walls with 10mm GIB standard stopped to level 4 for selected paint finish.

**FLOOR (F)**

- F01 CARPET OVERLAY OVER INTERIOR DRY DRESSED FLOORING**  
Selected carpet as owner's preference over Selected type B 19mm @600 max. flooring comply with NZS 3604:2011 or 20 mm HD particle board flooring.
- F02 VINYL/LAMINATED TIMBER FLOORING.**  
Selected vinyl or laminated timber flooring as per owner's preference.
- F03 INTERIOR FLOOR TILES. (WET AREAS).**  
Selected floor tiles over Mapei Mapegum WPS wet area membrane (installed by Mapei NZ Ltd approved applicator) over James Hardie Tile&Slate underlay over 17mm H3.2 plywood flooring with blocking @400 Crs. (All Bathroom, Ensuite, Laundry,WC, Kitchen are Wet area.)
- F04 INTERIOR CONCRETE FLOOR SLAB-RIBRAFT SLAB**  
Refer engineer's drawings for details.

**MISC**

- FFL 59.80 Finished floor level
- 001 Door number
- W01 Window number
- SD Domestic smoke alarm as per NZS.
- Mechanical extract ventilation to bathrooms and kitchen hob.
- Gas meter board
- Meter board
- Switch board

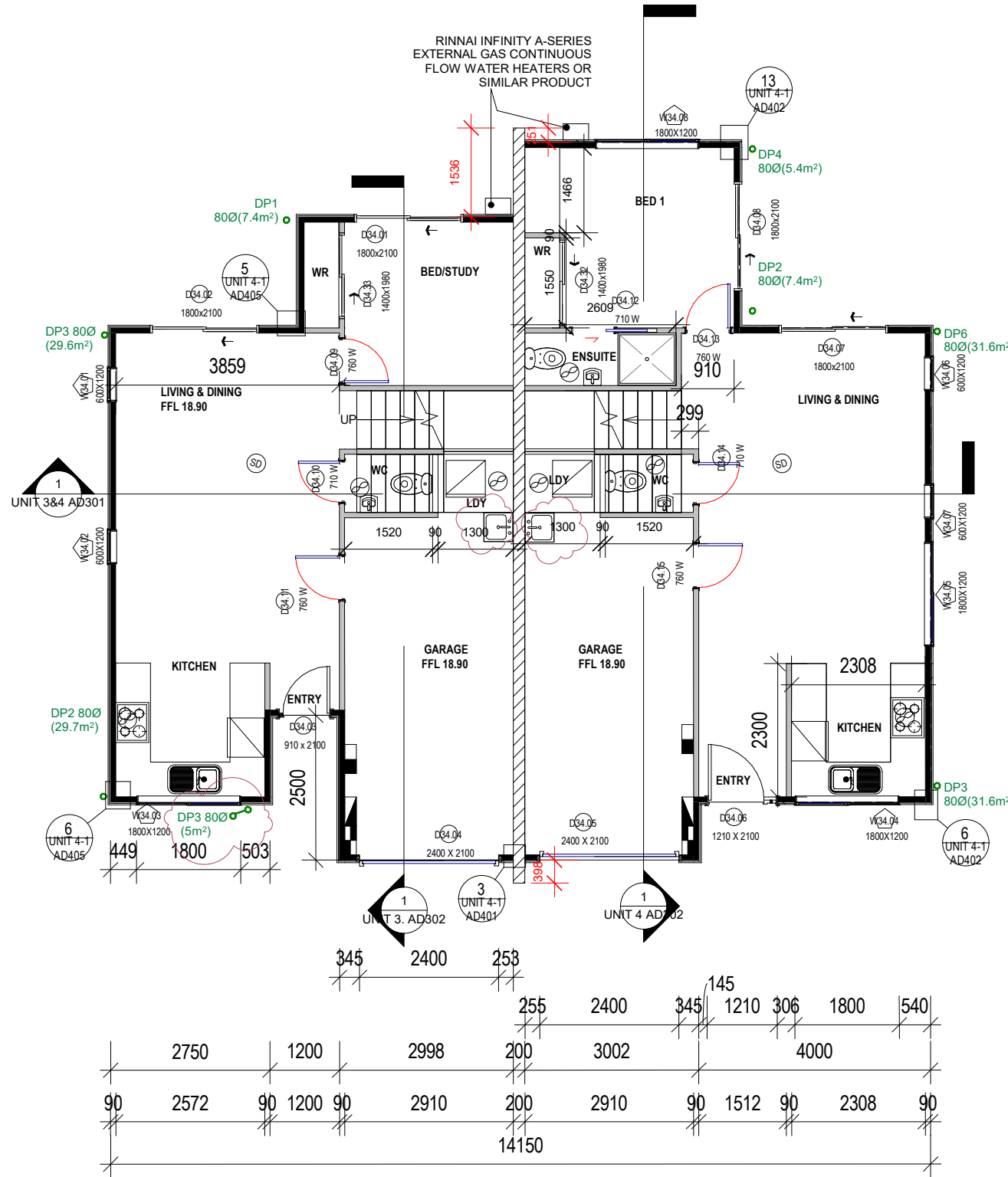
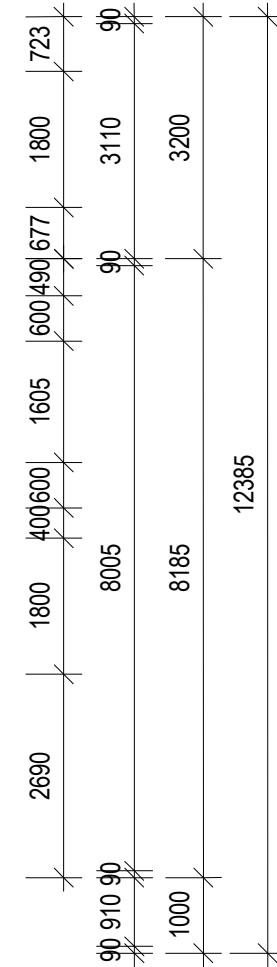
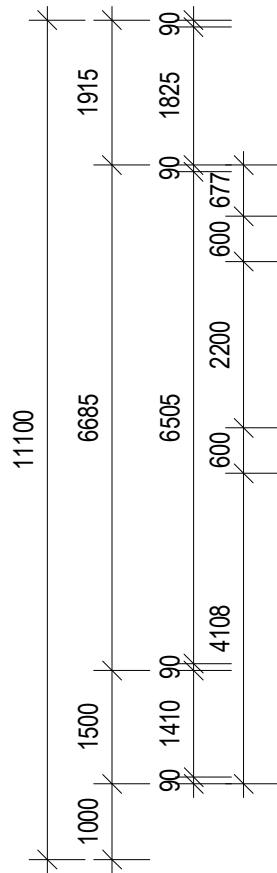
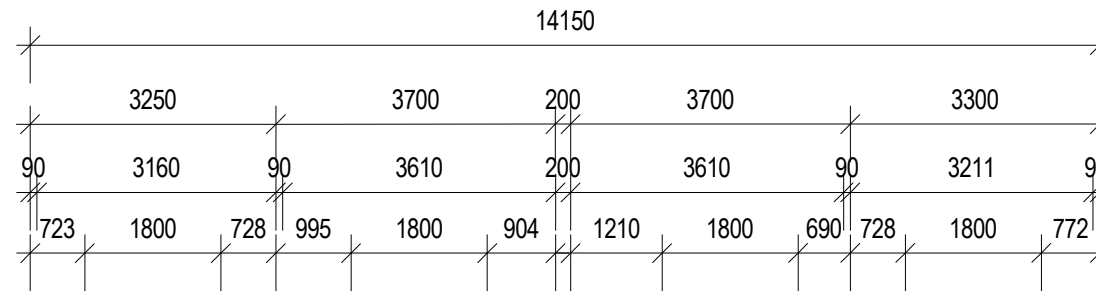

SPECIFICATION NOTE:  
ALL WORK TO COMPLY WITH THE NZ BUILDING CODE AND RELATED DOCUMENTS.  
ALL WORK TO BE CARRIED OUT IN ACCORDANCE WITH NZS 3604, 2011.

REV	DESCRIPTION	DATE

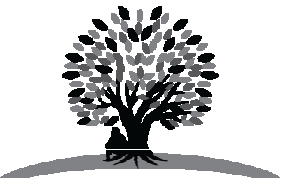

**FORREST STONE**  
Architecture & Design

Suite 8, Upper floor,  
The Jubilee Building,  
545 Parnell Road, Auckland.

P: 09 379 7353  
E: rocky@forrest-stone.co.nz



PROJECT

**(Unit 1-4)110 ELLIOT STREET  
PAPAKURA AUCKLAND 2113**

DRAWING TITLE

**GROUND FLOOR PLAN**

CLIENT REFERENCE

**Stonex Group Ltd**

SCALE	As indicated@A3
DATE	09-Nov-20 4:49:00 PM
DRAWN	RB/CP
CHECKED	RB
SHEET	REVISION

**UNIT 3&4  
AD105** **B**

THE CONTRACTOR SHALL CHECK AND VERIFY ALL DIMENSIONS, LEVELS AND ANGLES ON SITE PRIOR TO COMMENCING ANY WORK. THE COPYRIGHT TO THESE DRAWINGS AND ALL PARTS THERE OF REMAIN THE PROPERTY OF FORREST STONE, LTD. DIMENSIONS MUST NOT BE SCALE MEASURED FROM DRAWINGS.

1  
UNIT 1&2  
AD304

**UNIT 3&4 GROUND FLOOR PLAN**

1 : 100

**UNIT 3:**

**GROUND FLOOR AREA: 65.60m<sup>2</sup>**

**FIRST FLOOR AREA: 69m<sup>2</sup>**

**TOTAL FLOOR AREA: 134.60m<sup>2</sup>**

**UNIT 4:**

**GROUND FLOOR AREA: 72m<sup>2</sup>**

**FIRST FLOOR AREA: 49m<sup>2</sup>**

**TOTAL FLOOR AREA: 121m<sup>2</sup>**

REVISED



10/NOV/2020

PROFESSIONAL BUILDING  
CONSULTANTS LTD

**WALL(W)**

**W01 INTERNAL TIMBER FRAMED WALL.**  
90x45mm - Grade SG8 - H1.2 treated timber framed internal wall with studs as per framing table, and nogs at 800 crs. to comply with NZS3604, 2011. Line both sides with 10mm GIB standard stopped to level 4 for selected paint finish. In wet areas line walls with 10mm GIB Aqualine.

**W02 EXTERNAL TIMBER FRAMED WALL VERTICAL SHIPLAP-CAVITY BATTEN.**  
90x45mm - Grade SG8 - H1.2 treated timber framed external wall with studs at 600 crs. and nogs at 480 crs. to NZS 3604, 2011. Clad exterior with JAMES HARDIE LINEA OBLIQUE vertical(200mm wide or similar) weatherboard over building wrap over timber cavity batten. Line internal walls with 10mm GIB standard stopped to level 4 for selected paint finish.

**W03 EXTERNAL TIMBER FRAMED WALL. BEVEL BACK WEATHERBOARD - CAVITY BATTEN.**  
90x45mm - Grade SG8 - H1.2 treated timber framed external wall with studs at 600 crs. and nogs at 800 crs. to NZS 3604, 2011. Clad exterior with JAMES HARDIE LINEA OBLIQUE horizontal(200mm wide or similar) weatherboard over building wrap over timber cavity batten. Line internal walls with 10mm GIB standard stopped to level 4 for selected paint finish.

**FLOOR (F)**

**F01 CARPET OVERLAY OVER INTERIOR DRY DRESSED FLOORING**  
Selected carpet as owner's preference over Selected type B 19mm @600 max. flooring comply with NZS 3604:2011 or 20 mm HD particle board flooring.

**F02 VINYL/LAMINATED TIMBER FLOORING.**  
Selected vinyl or laminated timber flooring as per owner's preference.

**F03 INTERIOR FLOOR TILES. (WET AREAS).**  
Selected floor tiles over Mapei Mapegum WPS wet area membrane (installed by Mapei NZ Ltd approved applicator) over James Hardie Tile&Slate underlay over 17mm H3.2 plywood flooring with blocking @400 Crs. (All Bathroom, Ensuite, Laundry,WC, Kitchen are Wet area.)

**F04 INTERIOR CONCRETE FLOOR SLAB-RIBRAFT SLAB**  
Refer engineer's drawings for details.

**MISC**

**FFL 59.80** Finished floor level

- Door number
- Window number
- Domestic smoke alarm as per NZS.
- Mechanical extract ventilation to bathrooms and kitchen hob.
- Gas meter board
- Meter board
- Switch board

Auckland Council  
9/12/2020  
BCO10313868  
**APPROVED**  
BUILDING CONSENT PLANS

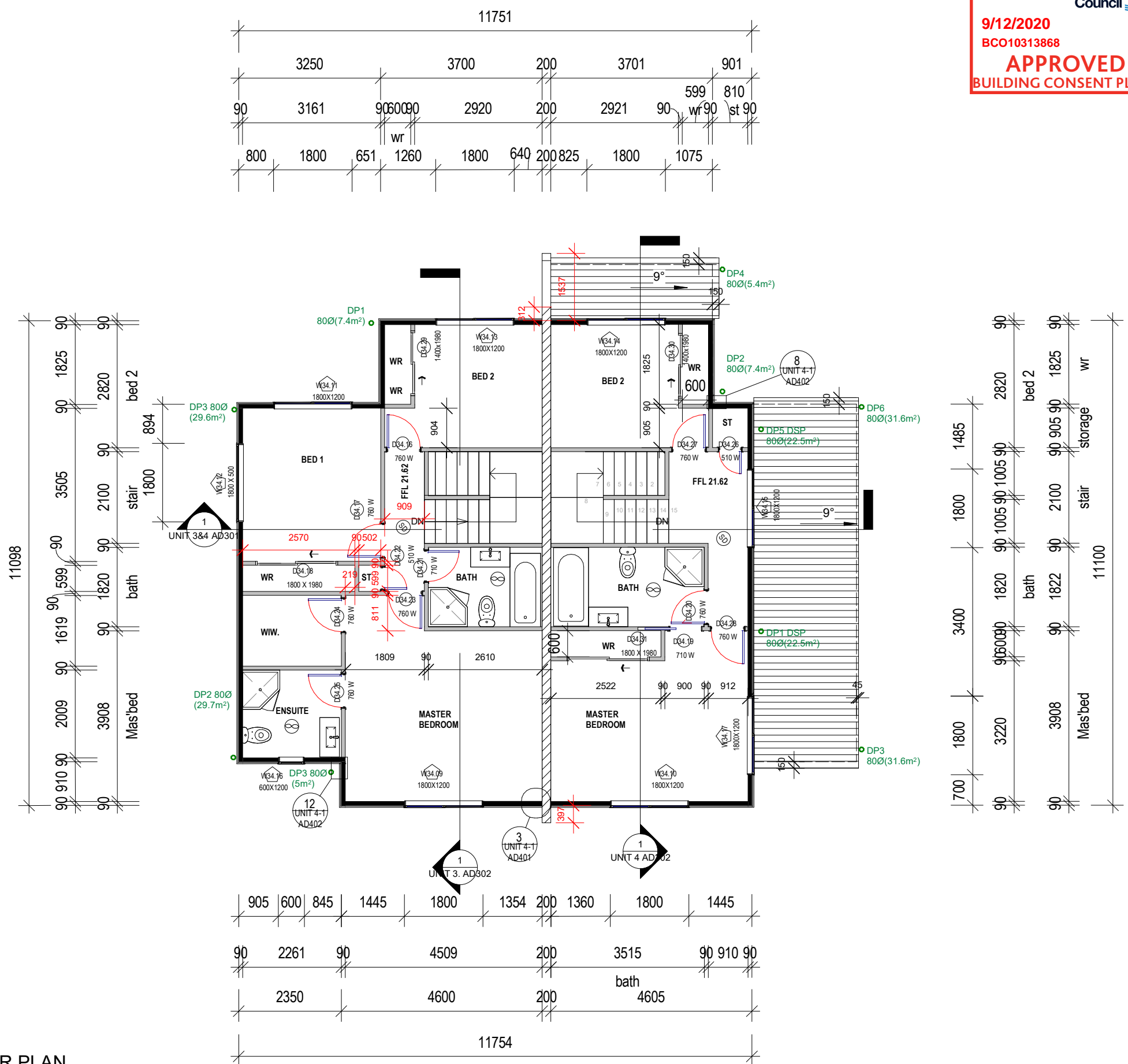

**SPECIFICATION NOTE:**  
ALL WORK TO COMPLY WITH THE NZ BUILDING CODE AND RELATED DOCUMENTS.  
ALL WORK TO BE CARRIED OUT IN ACCORDANCE WITH NZS 3604, 2011.

REV	DESCRIPTION	DATE

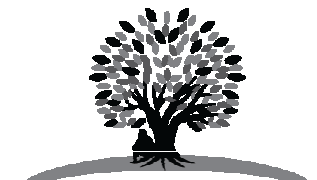

**FORREST STONE**  
Architecture & Design

Suite 8, Upper floor,  
The Jubilee Building,  
545 Parnell Road, Auckland.  
P: 09 379 7353  
E: rocky@forrest-stone.co.nz



PROJECT

**(Unit 1-4)110 ELLIOT STREET  
PAPAKURA AUCKLAND 2113**

DRAWING TITLE

**FIRST FLOOR PLAN**

CLIENT REFERENCE

**Stonex Group Ltd**

SCALE	As indicated@A3
DATE	09-Nov-20 4:49:02 PM
DRAWN	RB/ICP
CHECKED	RB
SHEET	REVISION

**UNIT 3&4  
AD106** **B**

THE CONTRACTOR SHALL CHECK AND VERIFY ALL DIMENSIONS, LEVELS AND ANGLES ON SITE PRIOR TO COMMENCING ANY WORK. THE COPYRIGHT TO THESE DRAWINGS AND ALL PARTS THERE OF REMAIN THE PROPERTY OF FORREST STONE LTD. DIMENSIONS MUST NOT BE SCALE MEASURED FROM DRAWINGS.

**UNIT 3&4 FIRST FLOOR PLAN**

1 : 100



**UNIT 3:**  
GROUND FLOOR AREA: 65.60m<sup>2</sup>  
FIRST FLOOR AREA: 69m<sup>2</sup>  
TOTAL FLOOR AREA: 134.60m<sup>2</sup>

**UNIT 4:**  
GROUND FLOOR AREA: 72m<sup>2</sup>  
FIRST FLOOR AREA: 49m<sup>2</sup>  
TOTAL FLOOR AREA: 121m<sup>2</sup>

**REVISED**  
10/NOV/2020  
PROFESSIONAL BUILDING CONSULTANTS LTD